

MARINE STAINLESS 316 SERIES ML-4 | ML-5 | ML-6 | ML-7 Tested under ASTM B119-19

** Features High Output LEDs

Tested under ASTM B119-19 method
 3000K / 4000K / 5000K User Selectable
 Stainless 316 High Polished Mirror finish
 Stainless Powder Coat finish, IP-65 rating
 DC 10-30V input, ML-4 (5W) 300 Lumens,
 ML-5 (5W) 300 Lumens, ML-6 (9W) 580 Lumens,
 ML-7 (12W) 790 Lumens

Available in Modern Trim or Traditional Trim

Modern Trim

Traditional Trim



White Trim



Polished Trim

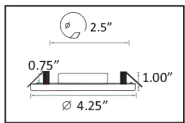

ML 4

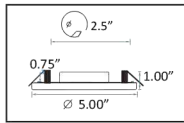

ML 5

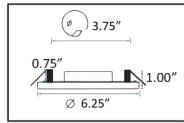

ML 6

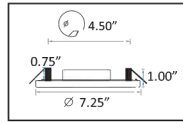

ML 7

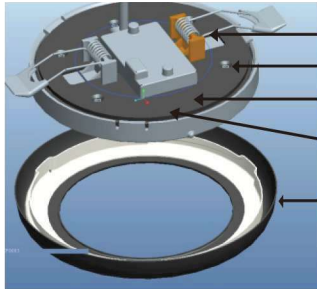

- Stainless spring loaded mounting clips
- Stainless mounting screws
- User Selectable CCT Switch (3000K, 4000K, 5000K)
- Permanent Gasket
- 316 Stainless mounting trim

Electrical rating:
 10-30V DC which will operate from 10V-16V & 22-28V
 12V DC will operate from 10-16 and dimmable
 24V DC will operate from 22-28V and dimmable

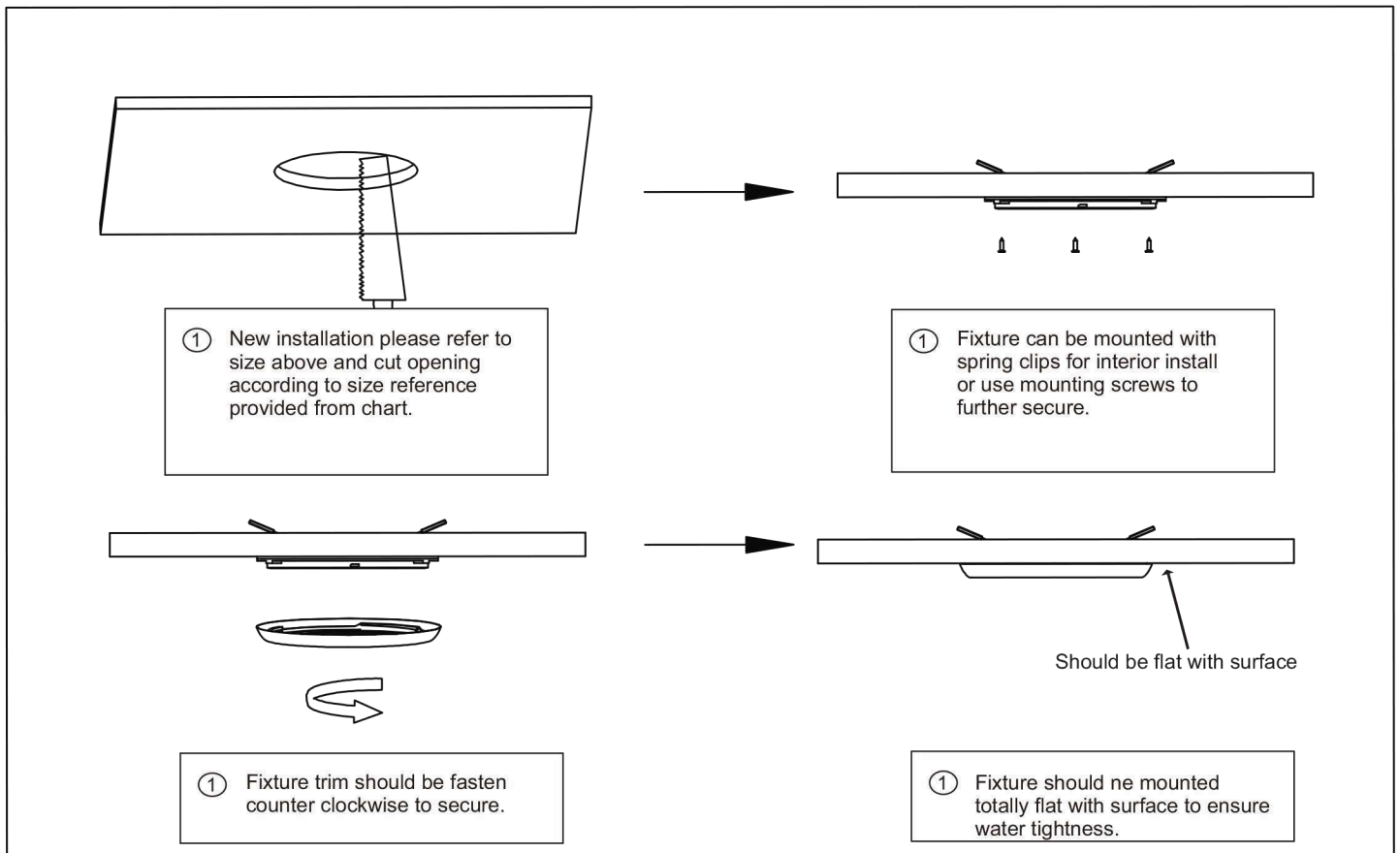

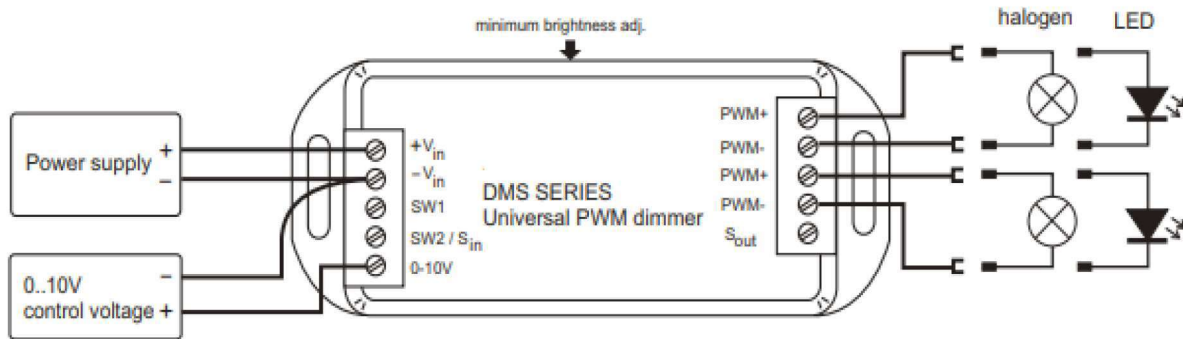
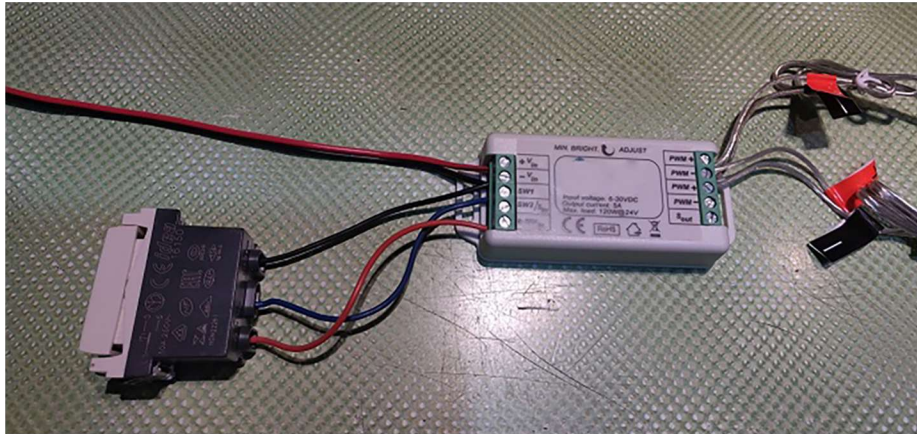

Wiring diagram for 0-10V control

NOTE: both sets of PWM outputs are internally connected in parallel

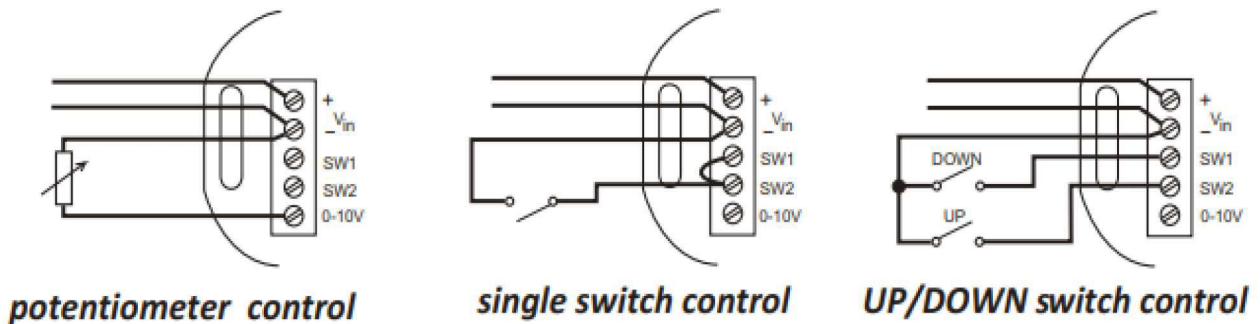

For 110/220Volts :

- Use Only Magnetic 110V/220V -12VDC Driver.
- For Dimming: Use Magnetic Dimmable Driver and Magnetic Low-Voltage Dimmer.
- Do not use 110V/220V-24VDC Driver